



Raising money for the MS Society



In association with and special thanks to...



and



**Welcome to the second Stockfest Tournament. Thanks for making the effort to get involved.**

Information on the venue, fixtures and tournament rules can be found within the pack.

### **The Venue**

The tournament is being held at the Stockport County FC Training Ground, which is located on Ridgeway Road in Timperley, Cheshire. The postcode is WA15 7EY for those with Sat Nav.

Alternatively the map below shows the local area.

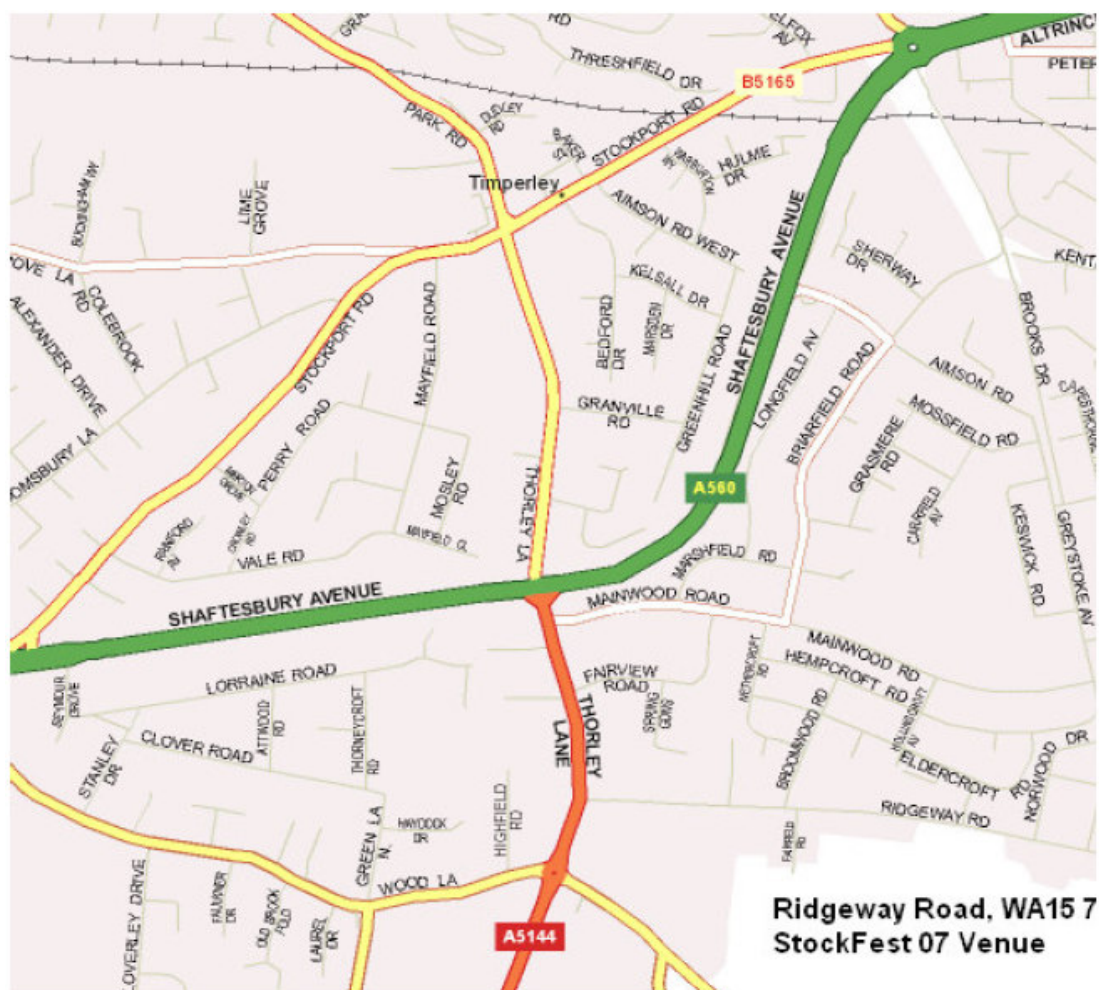

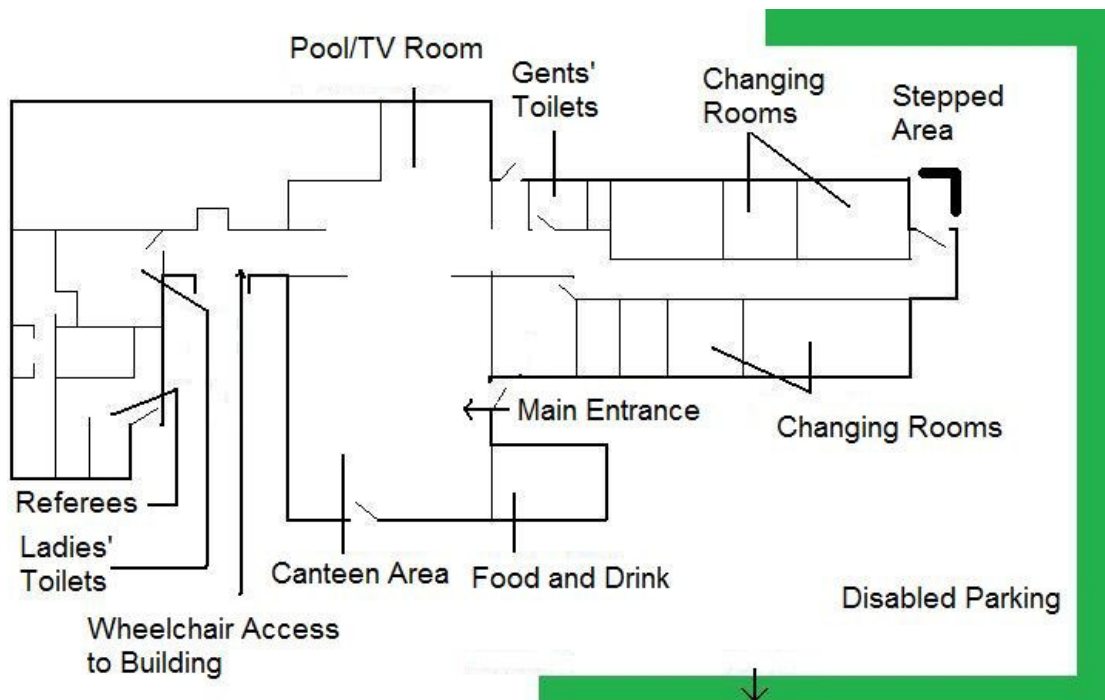

### Fixtures

The Stockfest draw was made on 9<sup>th</sup> May by the AeF Team Manager, Mark Smith. The tournament is split into two groups, with the top two of each group progressing to the semi finals. The bottom two of each will take part in a wooden spoon tournament. This means all teams get at least four games during the day, amounting to around 120 minutes.

All times are subject to change and it's up to teams to monitor what's happening on the pitches and at the admin desk. All teams are expected to provide Linesmen for the group games they have been allocated. Linesmen for the knockout stages will be decided on final group placing. Teams should check with the admin desk after the group stages to see if they will be needed to supply any linesmen for any more games.

The presentations of the Richard Harnwell Memorial Cup and Wooden Spoon will happen inside the main building near to the admin desk. This will happen shortly after the end of each final.

The groups were drawn as follows.

### Group A

Mansfield Town  
 Tranmere Rovers  
 Chester City  
 Stockport County

### Group B

Rotherham United  
 Hull City  
 West Bromwich Albion  
 Manchester United

TIME	GROUP/ ROUND	PITCH				LINESMAN
10.00	A	A	Mansfield	V	Tranmere	Rotherham
10.00	A	B	Chester	V	Stockport	Man Utd
10.40	B	A	Rotherham	V	Hull	Tranmere
10.40	B	B	Man Utd	V	WBA	Stockport
11.20	A	A	Tranmere	V	Chester	Hull
11.20	A	B	Mansfield	V	Stockport	WBA
12.00	B	A	Hull	V	Man Utd	Chester
12.00	B	B	Rotherham	V	WBA	Mansfield
12.40	A	A	Chester	V	Mansfield	Man Utd
12.40	A	B	Tranmere	V	Stockport	Rotherham
13.20	B	A	Rotherham	V	Man Utd	Chester
13.20	B	B	WBA	V	Hull	Tranmere

14.30	SEMI 1	A	Winners Group A	V	Runners Up Group B	4th placed Group A
14.30	SEMI 2	B	Winners Group B	V	Runners Up Group A	4th placed Group B
15.10	SPOON SEMI 1	A	3rd placed Group A	V	4th placed Group B	Winners Semi 1
15.10	SPOON SEMI 2	B	3rd placed Group B	V	4th placed Group A	Winners Semi 2
16.00	PLATE FINAL	A	Spoon Semi 1 W	V	Spoon Semi 2 W	Winners Semi 1
16.00	PLATE 3RD/4TH	B	Spoon Semi 1 L	V	Spoon Semi 2 L	Winners Semi 2
16.30	FINAL	A	Winners Semi 1	V	Winners Semi 2	Plate Winners
16.30	SPOON FINAL	B	Loser Spoon Semi 1	V	Loser Spoon Semi 2	Plate Losers

## Facilities

On arrival at Manor Farm you will be directed by a parking attendant to an area where you can leave your vehicle. You will also be given instructions on where to register your team and also where to get changed. Each of the important areas of the building will be signposted to make things easier for you.

There are changing facilities inside the main building, the capacity of which is estimated at around 3 or 4 teams at one time. With this in mind, if you're using the changing rooms please be aware there may be other teams waiting to use them. We don't envisage any problems with security, however we do recommend you take responsibility for your personal belongings during the day as we cannot be held responsible for lost, damaged or stolen property. There will also be showering facilities available on the day as well as ladies and gents toilets.

The gents is located at the far end of the changing block next to the showers. The ladies is adjacent to the referees room, to the left of the main hall as you look at it.

There are no food or drink outlets within easy walking distance so we have secured the services of a food vendor for the day. This will be located within the main hall and should also be accessible from the outside of the building too. Should you have any questions on the day, look out for people wearing orange MS Society t-shirts, or alternatively head to the admin desk.